

cecotec

PAPRIKA 2000 FULL

Procesador de alimentos / Food processor



Manual de instrucciones
Instruction manual
Manuel d'instructions
Bedienungsanleitung
Manuale di istruzioni
Manual de instruções
Handleiding
Instrukcja obsługi
Návod k použití

1. PARTS AND COMPONENTS

Fig. 1

1. Base
- a. Power knob
2. Jar lid/mould
3. Cover of the jar
4. Jar
5. Jar blade unit
6. Jar filter
7. Food pusher
8. Processing vessel lid
9. Tool holder
10. Processing vessel
11. Cutting blades unit
12. Kneading blade
13. Squeezing cone
14. Squeezing filter
15. Blade holder disc
16. Fine grinding blade
17. Thin cutting blade
18. French fries blade
19. Emulsifying disc

NOTE

The graphics in this manual are schematic representations and may not exactly match the appliance.

2. BEFORE USE

- This device is packaged in a way as to protect it during transport. Take the device out of its box and remove all packaging materials. You can keep the original box and other packaging elements in a safe place. This will help you prevent damage to the device when transporting it in the future. In case the original packaging is disposed of, make sure all packaging materials are recycled accordingly.
- Make sure all parts and components are included and in good conditions. If there is any piece missing or in bad conditions, contact the official Cecotec Technical Support Service immediately.
- Clean components that will come into contact with food with water and a non-abrasive detergent before first use.

Box content

- Food processor
- Squeezing cone and filter
- Kneading blade
- Cutting blade
- French fries blade
- Mincing blade
- Grating blade
- Emulsifying disc
- Blades support
- Instruction manual

3. ASSEMBLY

To carry out the assembly of the food processor, you must take into account that depending on the food you want to process, you will have to use one or other components. In general terms, however, the steps to be taken are as follows:

1. In any case, you must first place the container on the base so that it fits into the grooves and the position of the container is fixed and stable.
2. Then, place the tool holder on the motor shaft so that it is fixed and the two parts rotate with each other.
3. On the tool holder place the blade of your choice, whether it is a cutting blade, a kneading blade, the stirrer, the squeezing kit or the disc holder with the different options that fit into the recess of the holder for processing food.
4. If using any type of blade, the lid should be placed over the processing bowl and, if necessary, push the food into the recess to press it against the disc holder. The lid is fixed on the bowl, so it does not move and is stable, just like the rest of the components.

To assemble the jar, the steps to follow are as follows:

1. Place the blade in the jar, using the lower part of the measuring cup, which is fitted to the bottom of the blade to help you place it in the jar.
2. Place the jar, with the blades attached, on the processing base so that it is fixed and stable. Make sure that the jar fits tightly by moving it counterclockwise.
3. Cover the jar and use the mould whenever the blades are running to avoid splashing.
4. If the filter is to be used for the preparation of concentrates or vegetable drinks, it should be placed on the blades so that it is fitted into place, leaving the filter at the bottom and the plastic structure at the top.

4. OPERATION

- The power selector has three modes or speeds, and is used equally on both the jar and the processor:
- Speed mode 1 is usually powerful enough to grind any food. It is used in all cases at the beginning of processing.
- If necessary, due to the hardness or shape of the food, you can use speed mode 2 to give extra power to the processor.
- PULSE mode, indicated by a P on the selector, sets the processor to full power while it is active. It is used in cases where you want to chop or grind something hard that requires powerful but short impacts.
- The processor is designed for shredding in various forms, chopping, squeezing and kneading.

5. CLEANING AND MAINTENANCE

Cleaning

- To clean the blades properly, first rinse the container with water. Fill the jar with 400 ml of lukewarm water and add some detergent soap. Close the jar with the lid and run the machine in PULSE mode for 2 seconds at a time. Repeat the process as many times as necessary, both in the jar and in the processing container.
- To finish the cleaning, turn the power knob to the "0" position, turn the switch off and unplug the appliance after each use and before cleaning.
- Clean with water. Do not use chemical or harsh abrasive cleaning agents.
- Never submerge the motor base or the blade holder in water.
- Use a dry, soft cloth to clean the motor base. Do not clean this part with a wet cloth.
- The following parts are dishwasher safe: food pusher, processing bowl lid, tool holder, cutting blade unit, plastic kneading blade, blade support disc holder, fine shredding blade, fine cutting blade, french fries blade, squeezing cone and filter, stirrer, jar lid, jar mould, jar filter and jar.

Maintenance

If the product does not operate normally, produces uncommon noises or shakes more than it normally does, stop using the product and contact the Technical Support Service of Cecotec for reparation. Do not carry out maintenance tasks yourself.

Storage

- After cleaning the device, make sure it is thoroughly dried before storing it.
- After using the product, store it in a dry, safe place.
- Avoid direct exposure to sun light.
- Make sure it is stored in a place out of the reach of children.

6. TROUBLESHOOTING

Problem	Possible causes	Possible solution
The food processor does not work	The appliance is not plugged in.	Connect the mains plug to an earthed wall socket.
Food cannot be processed	Ingredients are too big.	Cut the food into several pieces, not too small, until it fits right through the feed hole in the cover of the processing bowl.
	Ingredients are too hard.	Due to the strength of the product, this does not usually occur, but some foods may be excessively hard. To soften them, place them for a few seconds in the microwave.
The shaft does not rotate	The tool being used has not been properly fitted.	Fit the tool properly on the shaft so that it rotates with it.
	The motor is blocked.	The motor may not work, even if the appliance is switched on. In that case, contact the official Technical Support Service of Cecotec.
White smoke comes out of the appliance.	The appliance is faulty	Contact the official Cecotec Technical Support Service.
The appliance is too hot	The motor has been blocked for too long	It is not usual, but it may be that the food is not being ground properly and the motor has been blocked for too long, causing it to overheat. Allow to cool for at least 10 minutes before reuse.

7. TECHNICAL SPECIFICATIONS

Product: Paprika 2000 Full

Product reference: 04361

Power: 1300 W

Engine blocking power: 2000 W

Voltage: 220-240 V

Frequency: 50/60 Hz

Technical specifications may change without prior notification to improve product quality.

Made in China | Designed in Spain

8. DISPOSAL OF OLD ELECTRICAL AND ELECTRONIC APPLIANCES



This symbol indicates that, according to the applicable regulations, the product and/or batteries must be disposed of separately from household waste. When this product reaches the end of its shelf life, you should dispose of the cells/batteries/accumulators and take them to a collection point designated by the local authorities.

Consumers must contact their local authorities or retailer for information concerning the correct disposal of old appliances and/or their batteries.

Compliance with the above guidelines will help protecting the environment.

9. TECHNICAL SUPPORT AND WARRANTY

Cecotec shall be liable to the end user or consumer for any lack of conformity that exists at the time of delivery of the product under the terms, conditions, and deadlines established by the applicable regulations.

It is recommended that repairs be carried out by qualified personnel.

If at any moment you detect any problem with your product or have any doubt, do not hesitate to contact the official Cecotec Technical Support Service at +34 963 210 728.

10. COPYRIGHT

The intellectual property rights over the texts in this manual belong to CECOTEC INNOVACIONES, S.L. All rights reserved. The contents of this publication may not, in whole or in part, be reproduced, stored in a retrieval system, transmitted, or distributed by any means (electronic, mechanical, photocopying, recording or similar) without the prior authorization of CECOTEC INNOVACIONES, S.L.

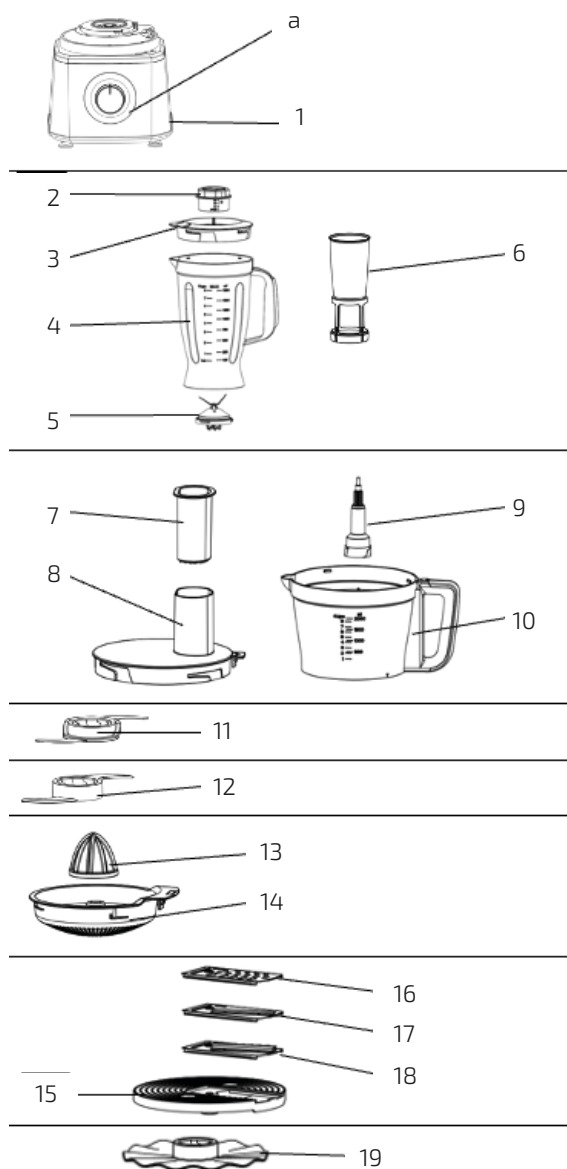

Fig./lmg./Abb./Afb./ Rys. 1

www.cecotec.es

Cecotec Innovaciones S.L.
Av. Reyes Católicos, 60
46910, Alfafar (Valencia), Spain
SF012300606